

TECHNICAL MEMORANDUM

**Subject: CORTE MADERA CREEK FLOOD CONTROL PROJECT
OCTOBER 2006 UNIT 4 DESIGN ALTERNATIVES**

APPENDIX B

Figure 33. Design Alternative I

Figure 34. Comparison of Variants Considered for Design Alternative II

Figure 35. Comparison of Variants Considered for Design Alternative III

Figure 36. Alternative IIA

Figure 37. Alternative IIB

Figure 38. Alternative III

Figure 39. Conceptual Cross-section

Figure 40. Design Alternative II Cross-sections

Figure 41. Design Alternative III Cross-sections

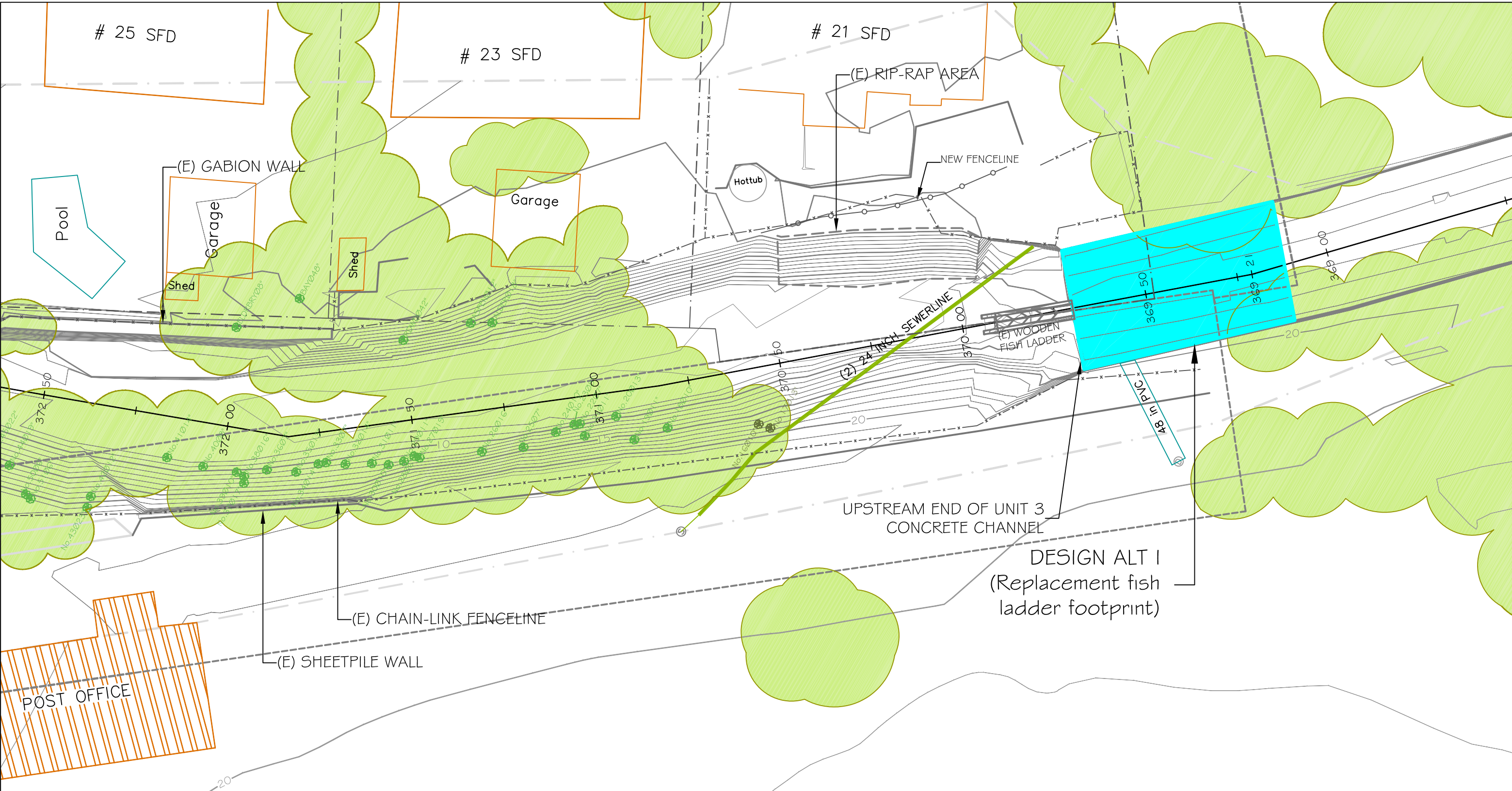

Legend

- No.48Ø22" Non-Native Tree
- No.47Ø12" Native Tree
- Design Alternative I (MLA - proposed replacement fish ladder within Unit 3)

CORTE MADERA CK. - UNIT 4 FEASIBILITY ANALYSIS

DESIGN ALTERNATIVE I



Stetson Engineers Inc.
2171 E. Francisco Blvd., Suite K
San Rafael, California 94901
Ph: (415)457-0701
Fax: (415)457-1638

FLUVIAL
GEOMORPHOLOGY
CONSULTING
Matt Smeltzer
(510) 219-1064 mobile
FluvialGeomorph@gmail.com

SCALE: 1" = 25'





DATE: 10/31/2006

Figure No.

33



Legend

-  47 Tree to be removed
-  48 Non-Native Tree
-  47 Native Tree
-  Design Alternative II - Retaining Wall Variants
-  Biotechnical Bank Stabilization Treatment Area (2)
(Limits of grading)

CORTE MADERA CK. - UNIT 4 FEASIBILITY ANALYSIS

COMPARISON OF VARIANTS CONSIDERED FOR DESIGN ALTERNATIVE II



Stetson Engineers Inc.
2171 E. Francisco Blvd., Suite K
San Rafael, California 94901
Ph: (415)457-0701
Fax: (415)457-1638

**FLUVIAL
GEOMORPHOLOGY
CONSULTING**
Matt Smeltzer
(510) 219-1064 mobile
FluvialGeomorph@gmail.com

SCALE: 1" = 60'

DATE: 10/31/2006

Figure No.

34



	<p>Legend</p> <ul style="list-style-type: none"> Tree to be removed Non-Native Tree Native Tree Design Alternative III - Retaining Wall Variants Biotechnical Bank Stabilization Treatment Areas (2) (Limits of grading) 	<h2 style="text-align: center;">CORTE MADERA CK. - UNIT 4 FEASIBILITY ANALYSIS</h2> <h3 style="text-align: center;">COMPARISON OF VARIANTS CONSIDERED FOR DESIGN ALTERNATIVE III</h3>		
<p>STETSON ENGINEERS INC.</p>	<p><i>Stetson Engineers Inc.</i> 2171 E. Francisco Blvd., Suite K San Rafael, California 94901 Ph: (415)457-0701 Fax: (415)457-1638</p>	<p>FLUVIAL GEOMORPHOLOGY CONSULTING Matt Smeltzer (510) 219-1064 mobile FluvialGeomorph@gmail.com</p>	<p>SCALE: 1" = 60'</p> <p>DATE: 10/31/2006</p>	<p>Figure No.</p> <h1 style="text-align: center;">35</h1>